

## ASSEMBLY INSTRUCTIONS

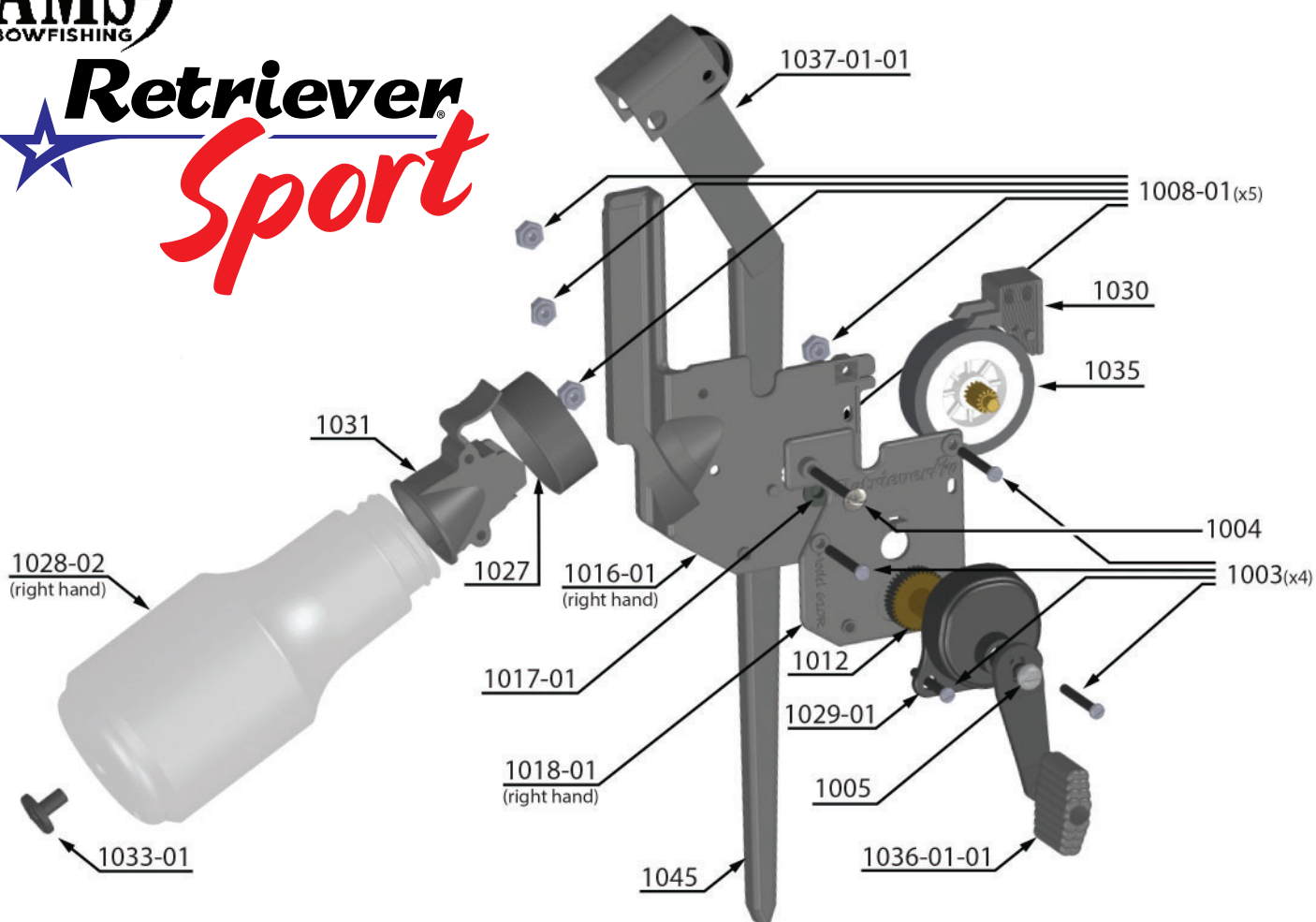

Refer to parts diagram to define parts.

Tools: Flat screw driver, 5/16" box wrench & marine grease

1. Push lock nuts (1008) into the back side of the mount plate (1016).
2. Place pinion bearing (1017) into mount plate, aligning small notch.
3. Grease both ends of the rubber drive roller (1035) and place the small end into the pinion.
4. Place line guide (1030) on the mount plate with the legs over the rubber drive roller.
5. To assemble gear cover: place gear cover (1029) over brass drive gear (1012), add handle (1036) and secure pieces together with the truss screw (1005).
6. Locate the small snap above the center hole on the side plate. Place gear cover assembly over it and slide it downward toward the bottom of the reel until it snaps onto the side plate.
7. Add side plate assembly to mount plate assembly. The two holes in the gear cover snap over the posts on the side plate. Secure with 1" screws (1003) at the bottom.
8. Add the line guide screw (1003). Secure with lock nut but do not tighten for later adjustment.
9. Pinch mount and side plates together to install the trigger assembly (1037) over the trigger bushings.
10. Assemble stripper (1031) and bottle cap (1027) by squeezing the cap slightly.
11. Push stripper/bottle cap between plates.
12. Align the holes in the trigger with the stripper and plates. Add the 1 ¼" screw (1004) through the trigger. Do not tighten yet as it will be adjusted later.
13. Add 1" stripper screw (1003) but do not tighten. You will adjust next.